

HBO-IC

Microlithography lamps for ASML i-line systems

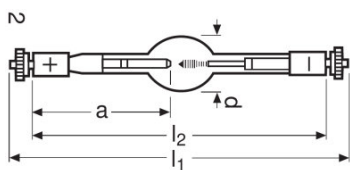

Product line drawing

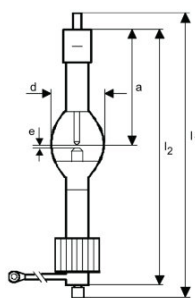

Product line drawing

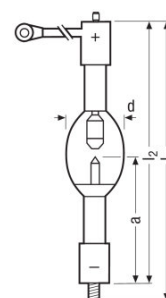

Product line drawing



Product family datasheet

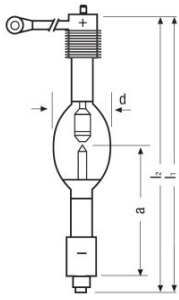

Product line drawing

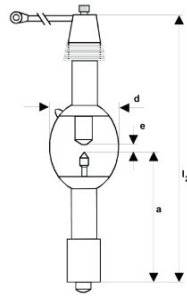

Product line drawing

Product family datasheet

Technical data

Product description	Electrical data					Dimensions & weight	
	Nominal voltage	Nominal current	Type of current	Rated wattage	Nominal wattage	Diameter	Length
HBO 1003 W/PIL	27.1 V	25.8 A	DC	700.00 W	700 W ... 1000 W	29.0 mm	195.0 mm
HBO 1500 W/PIL	23.0 V	65.0 A	DC	1500.00 W	1500.00 W	46.0 mm	273.0 mm
HBO 2100 W/PIL	23.9 V	88.0 A	DC	2100.00 W	2100.00 W	52.0 mm	240.0 mm
HBO 2500 W/PIL	28.0 V	83.3 A	DC	2500.00 W	2500.00 W	62.0 mm	340.0 mm
HBO 3500 W/PIL	23.0 V	148 A	DC	3400.00 W	3400.00 W	77.0 mm	360.0 mm
HBO 5500 W/PIL	27.0 V	204 A	DC	5500.00 W	5500.00 W	85.0 mm	325.5 mm

Product description	Mounting length	Length with base excl. base pins/connection	Light center length (LCL)	Electrode gap cold	Additional product data
					Base anode (standard designation)
HBO 1003 W/PIL	195.0 mm	167.50 mm	85.0 mm ¹⁾	3.0 mm	SFcX14-6/25 ²⁾
HBO 1500 W/PIL	273.0 mm	240.00 mm	118.0 mm ¹⁾	4.0 mm	SFc30-6/25 ⁶⁾
HBO 2100 W/PIL	273.0 mm	240.00 mm	118.0 mm ¹⁾	4.0 mm	
HBO 2500 W/PIL		312.50 mm	149.0 mm ¹⁾	7.0 mm	SFa30-6/50 ⁷⁾
HBO 3500 W/PIL		320.00 mm	154.0 mm ¹⁾	4.5 mm	SFaX40-6/50 ⁷⁾
HBO 5500 W/PIL	355.0 mm	352.50 mm	154.0 mm ¹⁾	5.5 mm	SFcX42.5-6/50 ⁹⁾

Product description	Base cathode (standard designation)	Capabilities		
		Dimmable	Cooling	Burning position
HBO 1003 W/PIL	SFc15-6/25 ³⁾	No	Forced ⁴⁾	Other ⁵⁾
HBO 1500 W/PIL	SFc27-10/35	No	Forced ⁴⁾	Other ⁵⁾
HBO 2100 W/PIL		No		Other ⁵⁾
HBO 2500 W/PIL	SFc30-6.5/50	No	Forced ⁴⁾	Other ⁸⁾
HBO 3500 W/PIL	SFc32.5-6.7/50	No	Forced ⁴⁾	Other ⁸⁾
HBO 5500 W/PIL	SFa37.5-9/50	No	Forced ⁴⁾	Other ⁸⁾

¹⁾ Distance from end of base to tip of anode or cathode (cold)

²⁾ With cooling fins

³⁾ With thread (M6)

⁴⁾ Maximum permissible base temperature: 200 °C

⁵⁾ Anode underneath

⁶⁾ Cooling fins and cable connection (M 8)

⁷⁾ With cooling fins and cable connection (M 10)

⁸⁾ Anode on top

⁹⁾ With cable connection (M 10)

Product family datasheet

Safety advice

Because of their high luminance, UV radiation and high internal pressure (when hot) HBO lamps may only be operated in enclosed lamp casings specially constructed for the purpose. Mercury is released if the lamp breaks. Special safety precautions must be taken. More information is available on request or can be found in the leaflet included with the lamp or in the operating instructions.

Application advice

For more detailed application information and graphics please see product datasheet.

Disclaimer

Subject to change without notice. Errors and omission excepted. Always make sure to use the most recent release.