

## HBO 2100 W/PIL

HBO-IC | Microlithography lamps for ASML i-line systems



# Product datasheet

## Technical data

### Electrical data

Nominal voltage	23.9 V
Nominal current	88.0 A
Type of current	DC
Rated wattage	2100.00 W
Nominal wattage	2100.00 W

### Dimensions & weight

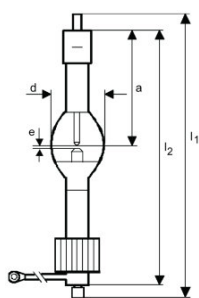

Diameter	52.0 mm
Length	240.0 mm
Mounting length	273.0 mm
Length with base excl. base pins/connection	240.00 mm
Light center length (LCL)	118.0 mm <sup>1)</sup>
Electrode gap cold	4.0 mm

<sup>1)</sup> Distance from end of base to tip of anode or cathode (cold)

### Capabilities

Dimmable	No
Burning position	Other <sup>1)</sup>

<sup>1)</sup> Anode underneath

## Product datasheet

---

### Safety advice

Because of their high luminance, UV radiation and high internal pressure (when hot) HBO lamps may only be operated in enclosed lamp casings specially constructed for the purpose. Mercury is released if the lamp breaks. Special safety precautions must be taken. More information is available on request or can be found in the leaflet included with the lamp or in the operating instructions.

---

### Logistical Data

Product code	Product description	Packaging unit (Pieces/Unit)	Dimensions (length x width x height)	Volume	Gross weight
4050300800431	HBO 2100 W/PIL	Sliding sleeve 1	385 mm x 195 mm x 160 mm	12.01 dm <sup>3</sup>	1149.00 g
4050300800448	HBO 2100 W/PIL	Shipping carton box 6	510 mm x 420 mm x 420 mm	89.96 dm <sup>3</sup>	7808.00 g

The mentioned product code describes the smallest quantity unit which can be ordered. One shipping unit can contain one or more single products. When placing an order, for the quantity please enter single or multiples of a shipping unit.

---

### Disclaimer

Subject to change without notice. Errors and omission excepted. Always make sure to use the most recent release.